

## Please follow the steps below:

1. Select the 'ESET' button   
This is located on the bottom Right Hand corner of your desktop.  
If not shown, ensure to check your 'Hidden Icons'.
2. If you are prompted, select 'Open ESET'
3. Press Ctrl + U on your keyboard to open the Username and Password setup window.



4. Your license details will now be shown within the program.

Please enter the Username and Password received after purchase or activation. We strongly recommend that you copy (Ctrl+C) from your registration email and paste (Ctrl+V) to the appropriate fields below.

Username:

Password:

If the above steps do not allow you see your license details, please follow the steps below:

1. Select the 'ESET' button   
This is located on the bottom Right Hand corner of your desktop.  
If not shown, ensure to check your 'Hidden Icons'.
2. If you are prompted, select 'Open ESET'
3. Select 'Setup' on the Left Hand side of the program.

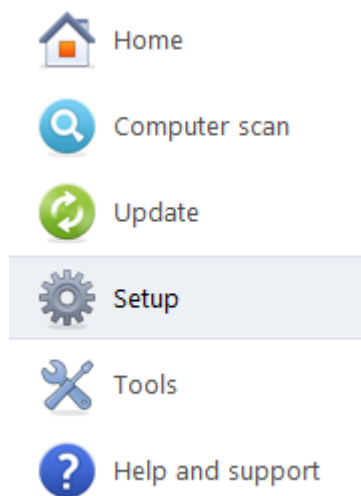

4. Select 'Product Activation'.

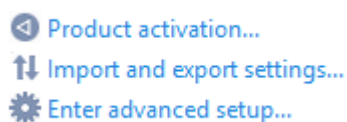

5. A new window will open, select 'Activate using a Username and Password'.

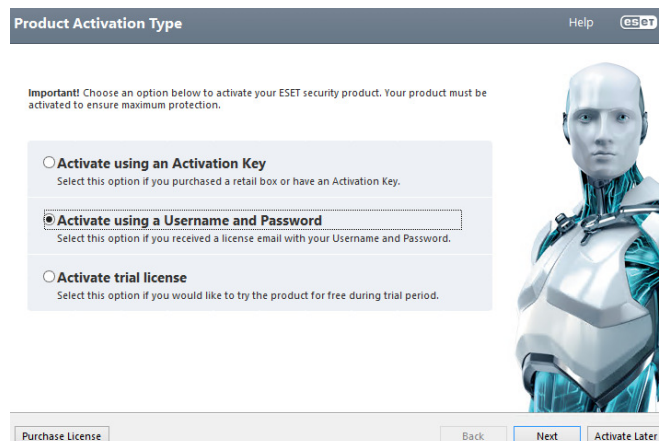

6. Your license details will now be shown within the program.

### Activate using a Username and Password

Please enter the Username and Password received after purchase or activation. We strongly recommend that you copy (Ctrl+C) from your registration email and paste (Ctrl+V) to the appropriate fields below.

Username:

Password:

**Please don't hesitate to contact the Microbe Support Team if you require any further information or assistance.**